

Tuberculin 1.0 mL

English



UNITRACT  [®]TM
Passive Sharps Protection

1mL Tuberculin Syringes with retracting needle

Quick Reference Guide Instructions for Pressurizing a Vial

1 Remove cap and draw up air into the syringe (0.1mL more than the dose required).

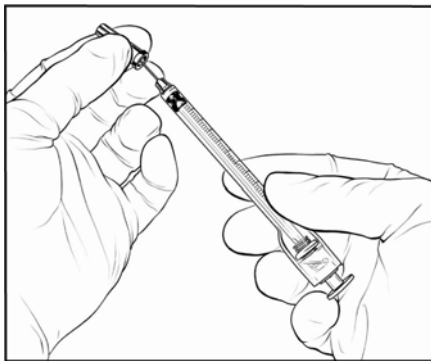

2 A. Inject the air into the vial—do not push the plunger beyond the 0.1mL mark.^I
B. Draw up required dose—always pull the plunger beyond the 0.2mL mark.^{II}

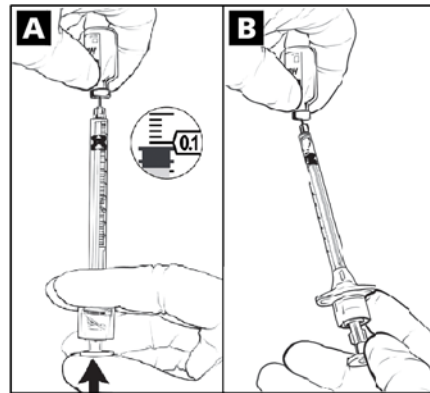

I. To prevent premature needle retraction do not push the plunger beyond the 0.1mL mark.
II. To initiate injection—for doses less than 0.2mL, ensure the plunger is pulled back beyond the 0.2mL mark.

3 A. Expel any excess air or fluid.
B. Insert needle,^{III} then push down on the plunger to inject entire dose, passing through any resistance from the needle engagement.^{IV}

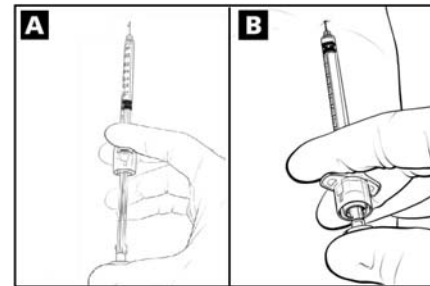

III. Prepare and give injections using aseptic technique according to institutional policy, or as directed by a healthcare professional.
IV. Operators should feel and hear the activation of the automatic retraction mechanism. Pressure should be applied on the plunger until it reaches the zero mark.

4 Operators can control the speed of automatic needle retraction^V directly from the body.^{VI}

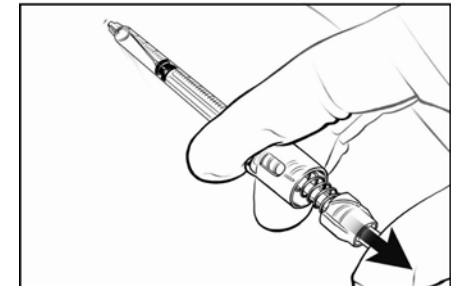

V. By adjusting thumb and finger pressure on the plunger.
VI. After use, discard in an appropriate container.