

Insulin
U-100
1.0 mL

English



UNI TRACT  [®]TM
Passive Sharps Protection

1mL Insulin Syringes with retracting needle

Quick Reference Guide Instructions for Pressurizing a Vial

1 Remove cap and draw up air into the syringe (10 units more than the dose required).

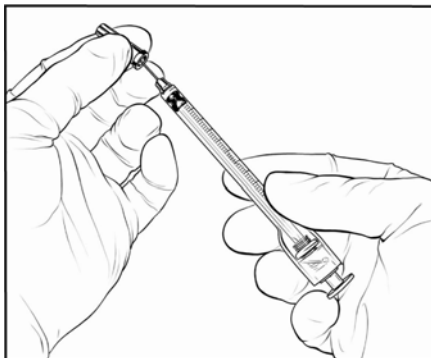

2 A. Inject the air into the vial—do not push the plunger beyond the 10 unit mark.^I
B. Draw up required dose—always pull the plunger beyond the 20 unit mark.^{II}

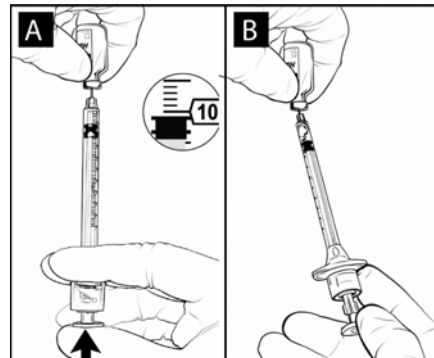

- I. To prevent premature needle retraction do not push the plunger beyond the 10 unit mark.
- II. To initiate injection—for doses less than 20 units ensure the plunger is pulled back beyond the 20 unit mark.

3 A. Expel any excess air or fluid.^{III}
B. Insert needle,^{IV} then push down on the plunger to inject entire dose, passing through any resistance from the needle engagement.^V

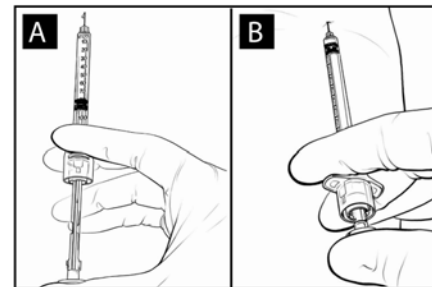

- III. Patients who mix two types of insulin should not change the order or process of mixing.
- IV. Prepare and give injections using aseptic technique according to institutional policy, or as directed by a healthcare professional.
- V. Operators should feel and hear the activation of the automatic retraction mechanism. Pressure should be applied on the plunger until it reaches the zero mark.

4 Operators can control the speed of automatic needle retraction^{VI} directly from the body.^{VII}



- VI. By adjusting thumb and finger pressure on the plunger.
- VII. After use, discard in an appropriate container.